

Flat Plate and Metalclad Grid Frames

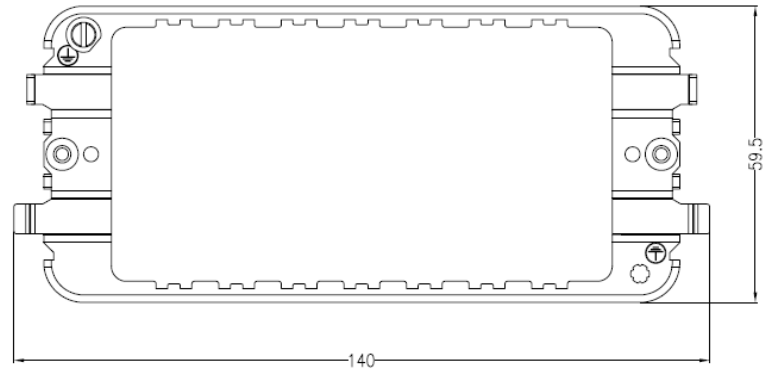

MLA part code	GDF001F	GDF002F
Description	Grid mounting frame for Flat Plate & Metalclad	
Nett weight (kg)	0.030	0.040
Dimensions (mm)	Height – 67.5 Width – 79.5	Height – 59.5 Width – 140
Number of modules	1-2G	3-4G
Earth terminal	Yes	
Construction	Premium grade steel	
IP rating	IP20	
Warranty	15 Years	
Origin of Manufacture	China	
Declaration of Conformity (held on file)	Yes	
EAN	5055832962793	5055832962809

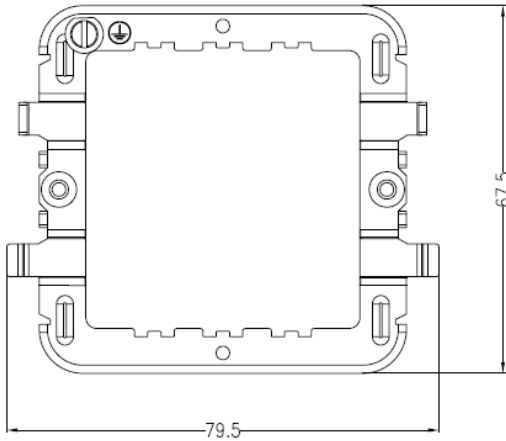