

AIR22 Air Separator

Tower Air separator

- Expels air from open-vented heating systems
- No moving parts – continuous air removal during system operation
- Available for 22mm and 28mm pipework
- Optional version with 'cold-feed' connection
- Suitable for soldered pipework connections only

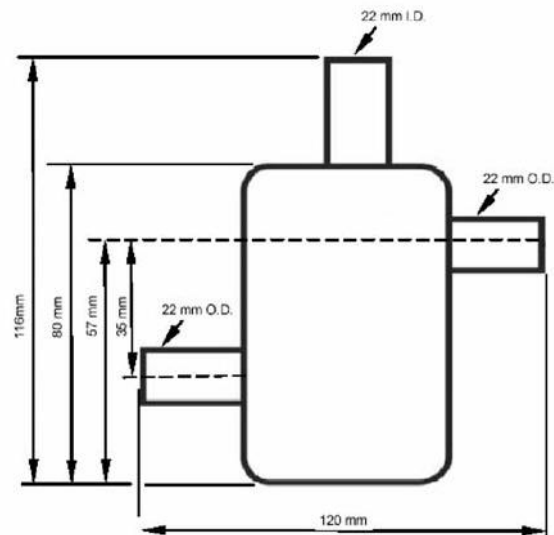

22mm air separator dimensions

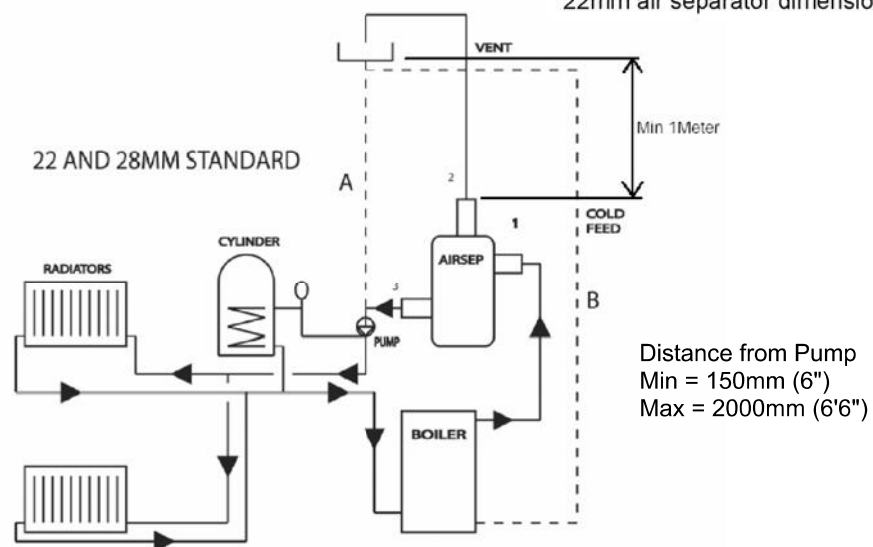

Typical installation layout

Distance from Pump
Min = 150mm (6")
Max = 2000mm (6'6")